

THE ULTIMATE 1000 LIFT™

Manual

Operation & Maintenance

Models
ML-013P
ML-014W

MORTUARY LIFT™ COMPANY

A L i f t i n g E x p e r i e n c e ™



127 Cottage Grove Avenue S.E.
Cedar Rapids, Iowa 52403
800-628-8809 • 319-364-4910
www.mortuarylift.com

OPERATING INSTRUCTIONS

THE ULTIMATE 1000 LIFT™



TO OPERATE THE *THE ULTIMATE 1000 LIFT™*:

The lift is capable of raising and lowering deceased remains with GLIDETEC STRAPS and caskets with BLACK NYLON CASKET STRAPS. To raise remains or caskets, secure all use specific straps under the remains/casket and to the white nylon straps, press the “Raise” button on the ONE TOUCH CONTROL UNIT or WIRELESS REMOTE CONTROL. To lower remains press the “Lower” button on the ONE TOUCH CONTROL UNIT or WIRELESS REMOTE CONTROL.

CAUTION: 1. Never lift living person with the lift.



2. Never lift human remains more than three feet above the casket or preparation table unless they are in a locked casket.
3. Never lift a casket from one floor to the next without first locking the casket closed.
4. Black nylon straps are used to lift caskets and deceased bodies weighing over 400lbs.
5. Never place black nylon casket straps under the casket. Always go over the top of the casket.
6. Never use the lift to lift a casket that does not have a middle hinge.
7. Never lift anything that is not human remains or a casket.
8. Never stand under the machine when there is a body of casket on it.
9. Never use Glidetec straps for bodies over 400
10. Mortuary Lift Company recommends replacing pivot bolt every 5 years.

GLIDETEC™ BODY STRAPS: 400 LBS. CAPACITY

(For bodies weighing over 400lbs use black nylon casket straps)

Yearly replacement recommended (see Strap placement DVD) These are the white plastic straps that are 36 inches length. They are to be used when lifting remains. Place one strap under the shoulder region, one under the buttock/ lower back region, and one under the knee region. To place these straps under the body, two techniques may be used.

TIPS:

- A. Always use straps with the ridges touching the remains.
- B. Sliding a strap under the knee region and lifting with the machine will help when trying to slide a strap under the buttock/lower back region.
- C. Slide one strap under the lower back region and lift the remains. This will allow enough room under the remains to help with dressing or adjusting garments.



**WHEN USING GLIDETEC STRAPS
DO NOT EXCEED 400 LBS.**

1. Start from either the left or right side of the remains, take one end of the strap and push it under the selected region of the body.
2. Start from the head region and shimmy the strap down the length of the remains. This is the preferred technique in large cases.
3. Attach hooks from the white nylon straps to the grommets of the Glidetec Straps.
4. Attach the head strap to the white nylon straps.
5. Use the attached yellow pendant or the remote control, depending on your model, to raise and lower the body.



**UNPLUG THE MACHINE IF ONE TOUCH
CONTROL UNIT/REMOTE CONTROL FAILS
TO STOP THE MACHINE FROM GOING
UP AND DOWN.**

BLACK NYLON STRAPS:

For use with lifting caskets and cadavers weighing over 400 lbs.

Yearly replacement recommended. These are the black nylon straps, which are 8 feet in length and have a metal “D” ring at each end. These are to be used when lifting a casket and remains over 400lbs.. The recommended way to lift a casket is to:

TO LIFT CASKET:

1. Lock the casket closed.
2. Attach one end of the black nylon casket strap to the corresponding white nylon strap hanging from the machine.
3. With the free end of the black nylon casket strap, weave up and between the casket side bar and the casket, making sure you are between the end hinge and the middle hinge (hinges connect the side bar to the casket.)
4. Bring the casket strap over the top of the casket.
5. Weave the strap down the other side between the casket and casket side bar. Again, making sure you are between the end hinge and the middle hinge.
6. Bring the casket strap up on the outer side of the casket side bar.
7. Attach the free end of the casket strap to the corresponding white nylon strap hanging from the other side of the machine.
8. Continue to do the same for the other two casket straps.
9. Once this has been done to all three straps, you are ready to lift the casket.



HEAD SLING:

Yearly replacement recommended.

This is the eye shaped fabric/plastic piece which has nylon webbing sewn to it. The webbing can be adjusted to accommodate your needs. The hooks on the head sling are to be attached to the two rings that are attached to the two white nylon straps at the head end of the machine.



ALWAYS INSPECT YOUR STRAPS

To insure that our products remain in good condition, make sure you regularly inspect your straps for excessive wear or damage.

Remove straps from service if any of the following damage is visible.

Never attempt to make a temporary strap repair.

1. Excessive abrasive wear.
2. Cuts, tears, holes, snags, or embedded particles.
3. Broken or missing stitches in load bearing splices.
4. Melted or charred spots.
5. Damaged eyes and/or damaged or deformed fittings.
6. Knots in any part of the straps.
7. Any other visible damage which causes doubt as to strength and safety.
8. Hooks or buckles are cracked or damaged in any way.

Inspect Glidetec Body Straps regularly for the following damage:

1. Stretching or tearing of plastic is visible.
2. Cracking of plastic is visible.
3. Excessive abrasive wear.
4. Metal grommets are loose or broken

TRACK SYSTEMS:

The ***THE ULTIMATE 1000 LIFT™*** moves manually along the track. The machine can be pulled by any of the six white nylon straps. Simply hold the white nylon strap above the buckle and pull the remains/casket to the necessary position.

CAUTION: Check ceiling attachments yearly. Tighten bolts as necessary.



FREEDOM PIVOT:

The Freedom Pivot allows the ***THE ULTIMATE 1000 LIFT™*** to pivot 180 degrees.

[See Freedom Pivot Installation manual for more details.]



DISCONTINUE USE AND CALL MANUFACTURER IF YOUR MACHINE IS SPINNING 360 DEGREES.

CAUTION: 1. Check pivot bolt yearly.



A. There should not be a gap between the metal base plate of the machine and the trolley. If there is a gap, DISCONTINUE USE until the bolt has been tightened.

2. Always leave one set screw in pivot.

Mortuary Lift Company recommends replacing pivot bolt every 5 years



UNPLUG THE MACHINE IF ONE TOUCH CONTROL UNIT/REMOTE CONTROL FAILS TO STOP THE MACHINE FROM GOING UP AND DOWN.

STRAP REPLACEMENT INSTRUCTIONS

WARNING

**FAILURE TO READ, UNDERSTAND AND FOLLOW
THESE INSTRUCTIONS MAY RESULT IN SEVERE
INJURY OR DEATH TO YOU OR OTHERS.**

1. Remove cover by unscrewing four bolts that attach it to the metal base of the machine. The molded plastic cover weighs approximately five pounds and should come completely off. [Place cover and bolts in a safe spot.]
2. Turn machine on and run all six straps completely down until you reach the end of the strap where it attaches to the pulley wheel (spool).
3. Remove the cotter pins from the pulley wheel by straightening the ends, then remove it from the spool. Discard old cotter pins.
Replacement cotter pins have been provided.
4. Remove and discard the sheer pin that holds the straps to the pulleywheel and shafting. New sheer pins have been provided.
5. All straps come from Mortuary lift Company rolled exactly the same way. If all straps are attached exactly the same way, all hooks and buckles will be facing inward so they don't snag on casket interiors.
6. In order to face all hooks and buckles inward, weave strap between the pulley wheel and the metal base of the machine (make sure that the roll of the strap is facing inward - towards the inside of the machine). *See diagram on page 9*

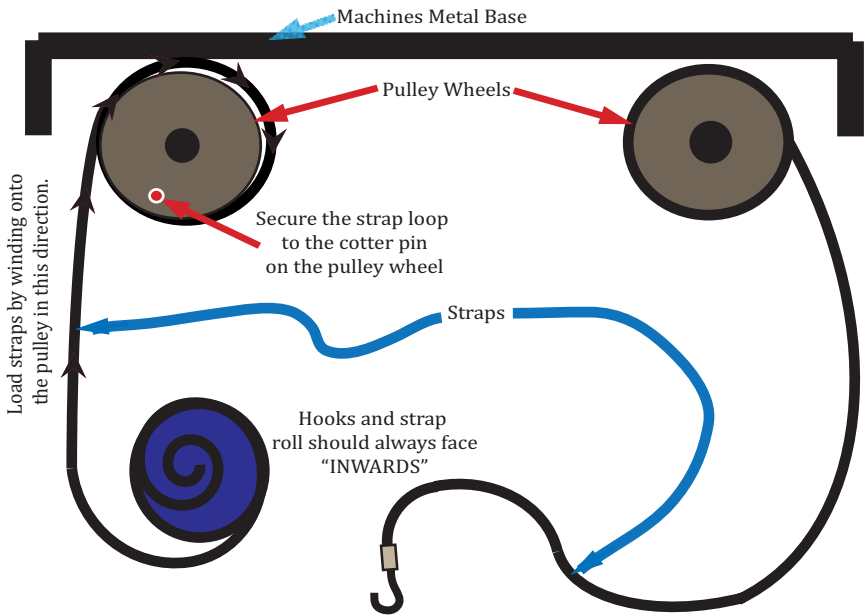

7. Place the new sheer pin through the grommet on the strap, the hole in the pulley wheel and the shafting. Then slide the new cotter pin through the side of the pulley wheel. With a wrench, bend open the end of the cotter pin.
8. Once all the straps have been attached to the pulley wheels with the sheer and sotter pins, turn on the machine and roll all the straps up. Make sure the straps stay on each pulley and do not twist.
9. Replace cover.

Convert Remote to Push Button Control For Model ML-014W



**IF THE REMOTE CONTROL FAILS
TO STOP THE MACHINE FROM
GOING UP AND DOWN, USE THE
FOLLOWING PROCEDURE.**

Convert Wireless to Push Button

1. Unplug the Ultimate 1000 Lift
2. Locate the push button box on the side of the machine
3. Locate the toggle switch on the bottom of the box
4. Flip the toggle from Wirelss to Push Button
5. Plug Ultimate 1000 Lift into a power source
6. The machine will now operate with the push buttons located on the cover.



Replace the battery in the remote control.
(Battery Size: CR 2032)

If the remote is still unresponsive after the battery is replaced, contact Mortuary Lift Company to order a new remote control.

Toggle

Convert Push Button to Wireless

1. Unplug the Ultimate 1000 Lift
2. Locate the push button box on the side of the machine
3. Locate the toggle switch on the bottom of the box
4. Flip the toggle from Push Button to Wirelss
5. Plug Ultimate 1000 Lift into a power source
6. The machine will now operate with the push buttons located on the cover.

How to Changing the Frequency on Your Wireless Remote Control For Model: ML-014W

WARNING

Failure to read, understand or follow these procedures may result in damage to your machine, severe injury to yourself or others, or even death.

You will need power to your machine to train your remote. DO NOT TOUCH the receiver board anywhere else except the learn button.

1. Remove cover from machine by removing four screws, two on either side.
2. Remove the black electrical cover.



SETTING THE TRANSMITTER ADDRESS

The key fobs are all supplied from the factory with a default signal and all buttons programmed to the old signal can be changed.

1. Use a paperclip to press the CREATE_ADDR button on the back of the case.
2. When the button is pressed, a light will light up in the



← **CREATE_ADDR**
Button Access

MODE_IND window indicating that the new signal is being initialized.

3. Once the button is released, the randomized address is saved and the LED light will begin flashing indicating that the Control Permission may now be set.
4. Press the CREATE_ADDR button with a paperclip again or wait 17 seconds for it to time out. The address and Control Permission are now set. The decoder will need to learn the address before it will accept any transmissions.

How to Sync the Receiver Board with the Remotes

Once the Keyfobs have had the control permissions set the receiver

board will need to learn the new addresses of the Keyfobs.

1. Press the learn button on the receiver board.
 2. With the LED light flashing on the board press the up and down buttons on the keyfob.
 3. Press the button on the receiver board again to turn off the LED light and test your Keyfobs new signal.
- [Do this process seperately for both remotes and test both after you have finished. If your remote does not work or only one button works, go back to setting the transmitter address and repeat the process over.]

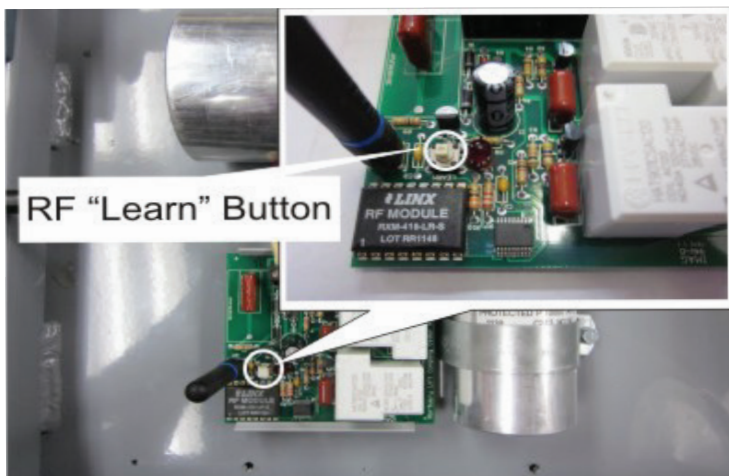

REMINDERS

1. Never operate without the cover on the machine.
2. Never remove warning stickers from cover of the machine.
3. Check integrity of nylon lift straps before each use.
4. Check integrity of nylon lift strap hooks before each use.
5. Check integrity of Glidetec straps before each use.
6. Check integrity of black nylon casket straps before each use.
7. Internally inspect and service machine yearly.
8. Never remove direction labels on the One Touch Control Unit or Remote Control Unit.
9. Never place hand inside the cover of the machine when machine is plugged in.
10. Never attempt to lift more than the specified weight limit:
up to 400lbs with the white Plastic Glidetec straps
up to 1000lbs with the black nylon straps
11. Never stand under the machine when it is lifting a casket or cadaver.
12. Never attempt to use nylon lift straps as a substitute for Glidetec body straps or casket straps.
13. DO NOT LIFT CASKETS THAT DO NOT HAVE CENTER HINGE THAT CONNECTS THE SIDE BAR TO THE CASKET.



UNPLUG THE MACHINE IF ONE TOUCH CONTROL UNIT/REMOTE CONTROL FAILS TO STOP THE MACHINE FROM GOING UP AND DOWN.

LIMITED WARRANTY
MORTUARY LIFT MODELS
ML-013P
ML-014W

THE ULTIMATE 1000 LIFT™

Mortuary Lift Company, Inc. ("MLC") warrants this product against defects in materials or workmanship as follows:

1.) For a period of one year from the date of purchase by the original retail purchaser, MLC or an authorized representative will repair or replace, free of charge, any part of the product, except for light bulbs and batteries, which its examination shall disclose to be defective in workmanship or materials.

2.) For a period of five years from the date of purchase by the original retail purchaser, MLC or an authorized representative will repair or replace any part of the product which its examination shall disclose to be defective in workmanship or material, except for any Glidtec Straps, casket straps, nylon straps, track system parts, remote keyfob or head slings. Such repair or replacement shall be free of charge, except for the cost of labor involved in such repair or replacement.

3.) For a period of ten years from the date of purchase by the original retail purchaser, MLC or an authorized representative will repair or replace the metal base of the product if an examination shall disclose such base to be defective in workmanship or material. Such repair or replacement shall be free of charge, except for the cost of labor involved in such repair or replacement.

This limited warranty applies only when the product is used and cared for as described in the instructions provided with the product. Improper use and care may void this warranty. This limited warranty further applies only to the original purchaser, and the warranty period begins the date the product was first purchased by the original purchaser or the date the original purchaser received it if they have proof of the delivery date. The limited warranty is not transferable or assignable in any manner. MLC offers no warranties or guarantees of any kind for products manufactured or installed by others, and assumes no liability for any products or installations.

MONEY BACK GUARANTEE

If the original retail purchaser is not satisfied with product, MLC will refund to such purchaser the full purchase price, subject to a \$2500.00 restocking fee, provided the purchaser returns the product in all the original packaging with all shipping and freight insured by the purchaser, in good condition to MLC within 60 days from the date of purchase. Cut track is non-refundable.

HOW TO OBTAIN WARRANTY SERVICE:

For warranty services call (800) 628-8809 or (319) 364-4910 or write to:

Mortuary Lift Company
127 Cottage Grove Avenue SE
Cedar Rapids, IA 52403

Units returned to MLC under this warranty must be shipped to the following address freight prepaid:

Mortuary Lift Company
329 10th Avenue SE, Suite 213
Cedar Rapids, IA 52401

Replacement units shipped to the customer will be sent freight prepaid by MLC.

WARRANTY LIMITATIONS

This limited warranty does not apply in the case of damage to the unit due to freezing, fire, flooding accident, misuse, abuse, alteration, improper handling and/or improper installation. In no event will Mortuary Lift Company be liable for incident or consequential damages from a defective unit or improper installation.

THIS LIMITED WARRANTY IS EXPRESSLY IN LIEU OF ALL OTHER WARRANTIES, EXPRESSED OR IMPLIED, INCLUDING, BUT NOT LIMITED TO, ANY IMPLIED WARRANTIES OF MERCHANTABILITY OR FITNESS FOR A PARTICULAR PURPOSE, AND ANY OTHER OBLIGATION OF MORTUARY LIFT COMPANY. THIS LIMITED WARRANTY IS NOT VALID UNLESS THE PRODUCT IS PURCHASED FROM AN AUTHORIZED MLC DEALER OR DISTRIBUTOR.

There is no warranty which extends beyond the description on the face hereof, and no person, representative or firm is authorized to commit MLC to further liability or obligation. This warranty is understood to be the complete exclusive agreement between the parties, superceding all prior agreements, oral or written, and all other communications between the parties relating to the subject matter of this agreement.

LIMITATIONS OF REMEDIES

In no cases shall MLC be liable for any special, incidental, or consequential damages based upon breach of warranty, breach of contract, negligence strict tort, or any legal theory.

YOUR RIGHTS UNDER THE STATE LAW:

This limited warranty gives you specific legal rights. you may also have additional rights under the laws of your state.

THE WARRANTY/REPLACEMENT REGISTRATION SHEET, ENCLOSED, MUST BE COMPLETELY FILLED OUT AND RETURNED TO MORTUARY LIFT COMPANY, WITHIN 30 DAYS OF RECEIPT OF MACHINE. IN ORDER TO VALIDATE THIS LIMITED WARRANTY/REPLACEMENT OFFER AND ESTABLISH YOUR DATE OF PURCHASE.

DATE OF PURCHASE

MODEL# _____

SERIAL# _____

(See sticker on base of machine)

DETACH AND MAIL TO:

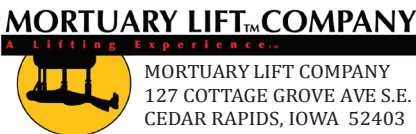

NAME _____

BUSINESS NAME _____

ADDRESS _____

CITY _____ STATE _____ ZIP _____

PHONE _____

PURCHASE DATE _____ SERIAL # _____

ITEM PURCHASED FROM _____

Revised 12/5/23

MORTUARY LIFT™ COMPANY

A L i f t i n g E x p e r i e n c e ™



THE ULTIMATE 1000 LIFT™

127 Cottage Grove Avenue S.E.
Cedar Rapids, Iowa 52403
800-628-8809 • 319-364-4910
www.mortuarylift.com